



If there is a rusty nut is hard to remove or replace, this specific tool is able to cut the nut off and remove it easily.



## Directly Screw Nut Cutting Tool

CNC-1924A

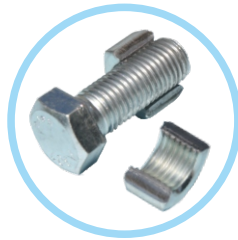

- ◆ A one-shaped EHV-hydraulic cutting machine uses two-stage manual oil output – high and low voltages. The max. output pressure: 700kgf/cm<sup>2</sup> (10000psi).
- ◆ Lightweight, easy to carry and operate, suitable for working high above the ground.
- ◆ The alloy-steel-made on the edge of a blade can get rid of all kinds of none-hardness screw nuts.
- ◆ Applicable to break bolts between the ranges: M12 to M16; nuts between the ranges: 19 to 24 (across flats-A/F).



CNC-2432A

- ◆ A one-shaped EHV-hydraulic cutting machine uses two-stage manual oil output – high and low voltages. The max. output pressure: 700kgf/cm<sup>2</sup> (10000psi).
- ◆ Lightweight, easy to carry and operate, suitable for working high above the ground.
- ◆ The alloy-steel-made on the edge of a blade can get rid of all kinds of none-hardness screw nuts.
- ◆ Applicable to break bolts between the ranges: M16 to M22; nuts between the ranges: 24 to 32 (across flats-A/F).

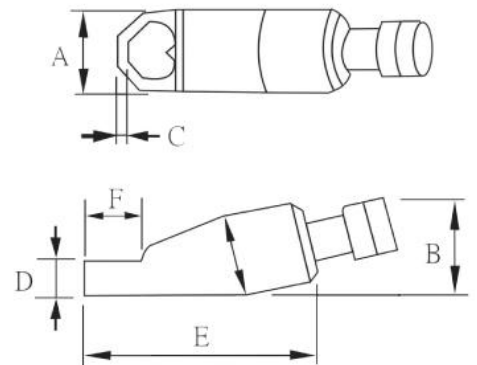

Item	Output (Ton)	Bolt Range (mm)	Hexagon Nut Range (mm)	Weight (Kg)	Sizes (mm)					
					A	B	C	D	E	F
CNC-1924A	10	M12-M16	A/F 19-24	4.5	40	48	6	19	119	28
CNC-2432A	17	M16-M22	A/F 24-32	7	55	71	8	25	153	38